

# SWING CHECK VALVE

Size DN50-DN600 PN16/PN25/Class125/Class250

**Fig. 5101-Bronze Disc Trim, Fig. 5102-Rubber Disc Trim**

## Specification

- Valves comply with EN 12334, BS5153, MSS SP-71 or AWWA C508.
- Globe shape to provide full flow with low pressure drop.
- Suitable for mounting in horizontal and vertical position (with vertical flow upwards).
- Available with flanges EN1092-2 PN10 or PN16, ANSI B16.1 Class125 (Other types available on request).

## Working Pressure

- Size 50mm - 600mm 16Bar
- Size 50mm - 300mm 25Bar

## Working Temperature

- -10°C to 120°C for Bronze or EPDM disc trim
- -10°C to 82°C for NBR disc trim

## Corrosion Protection

- Internally and externally liquid epoxy painted or fusion bonded epoxy powder coated (FBE).

## Notes:

- In Ductile Iron construction for PN25 or Class250.
- Design and material are subject to change without notice.



# WEFLO

## Material Specification and Dimensions

### Material Specification

| Part Name  | Materials       | EN Spec.      | ASTM Spec.         |
|------------|-----------------|---------------|--------------------|
| Body*      | Cast Iron       | EN-JL1040     | ASTM A126 Class B  |
| Cover*     | Cast Iron       | EN-JL1040     | ASTM A126 Class B  |
| Side Plug  | Brass           | CuZn39Pb3     | ASTM B16 C36000    |
| Hanger Pin | Stainless Steel | BS970 420S37  | AISI 420           |
| Hanger     | Ductile Iron    | EN-JS1050     | ASTM A536 65-45-12 |
| Disc*      | Cast Iron       | EN-JL1040     | ASTM A126 Class B  |
| Disc Trim  | Bronze          | EN1982 CC491K | ASTM B62 C83600    |
|            | EPDM/NBR        | Commercial    | Commercial         |
| Body Trim  | Bronze          | EN1982 CC491K | Non-asbestos       |
| Gasket     | Graphite        | Non-asbestos  | ASTM B62 C83600    |

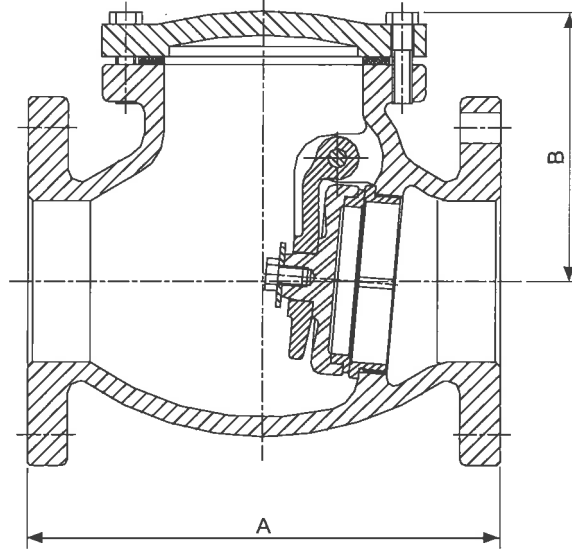

### Dimensions (mm)

| Size               | 50   | 65  | 80  | 100 | 125 | 150 | 200  | 250 | 300 | 350 | 400 | 450 | 500  | 600  |
|--------------------|------|-----|-----|-----|-----|-----|------|-----|-----|-----|-----|-----|------|------|
| <b>A</b>           | 203  | 216 | 241 | 292 | 330 | 356 | 495  | 622 | 699 | 787 | 914 | 914 | 1016 | 1219 |
| <b>B</b>           | 125  | 137 | 147 | 166 | 190 | 217 | 265  | 300 | 342 | 402 | 472 | 500 | 514  | 605  |
| <b>Weight (kg)</b> | 11.5 | 13  | 17  | 25  | 40  | 50  | 58.3 | 218 | 282 | 500 | 680 | 780 | 1000 | 1600 |

WEFLO VALVE COMPANY LTD.

145-157 ST JOHN STREET, LONDON, EC1V 4PY UNITED KINGDOM

Tel: +44(0) 207 256 7777

E-mail: info@weflovalve.com

Web: www.weflovalve.com